

## Door Handle Retro Fitting Kit

18685

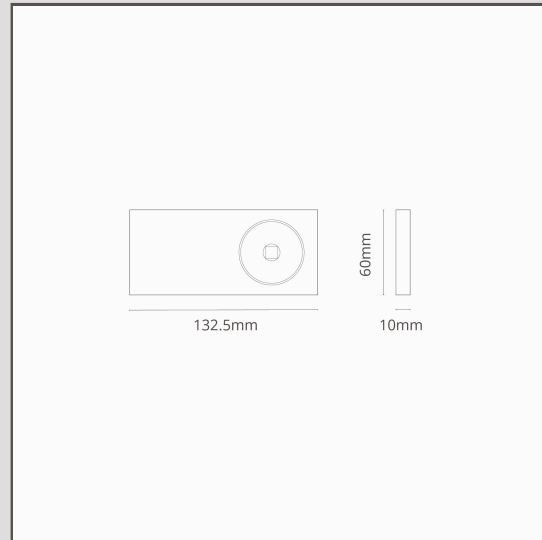
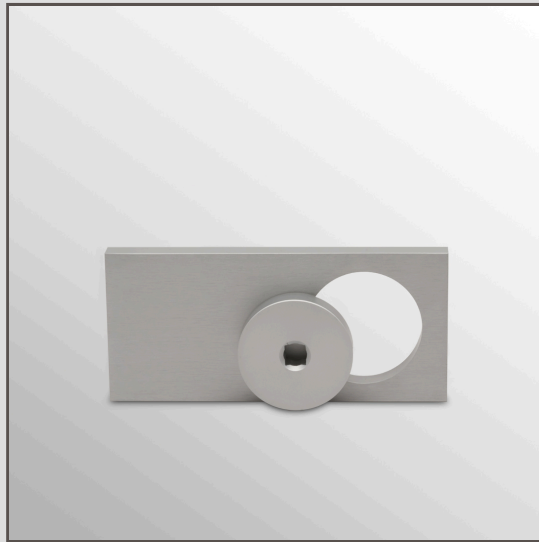

Our sprung door handles are designed with low-profile roses, so we've had to engineer the sprung mechanism so it recesses into your door.

To install any of our sprung door handles, you'll need to drill a 45mm pocket into the door for the mechanism. If you're installing the mechanism into a door that's previously had a handle, you'll need to use our bespoke retro fitting kit (you might know it as a jig).

This will provide an accurate guide for our 45mm Forstner drill bit, so the hole is created in the correct place. It'll stop the drill from wandering across – and possibly damaging – the door.

Watch our installation video [here](#) to see just how easy it is to use.